

# Standoffs

AND DISPLAY COMPONENTS

DISTRIBUTED  
IN CANADA BY...



Call us... **1-888-452-9019**  
780-452-9019 Edmonton, Ab.

Fax us... **1-780-451-1012**

Web Site... **[www.comsign.ca](http://www.comsign.ca)**

Email us... **[sales@comsign.ca](mailto:sales@comsign.ca)**

Visit us... 16208-116 Ave. Edmonton, Alberta T5M 3V4

Effective... **Jan. 2013** (Specifications subject to change without notice)



## Standoffs

This system consists of basic Stand Off caps and barrels; Edge Grips; Material Grippers and Hinges. Standoffs are machined to tight tolerances from solid aircraft grade aluminum. They are then polished to a bright satin finish and armoured with a six-dip clear anodize or colour finish which molecularly bonds to the metal's surface. All Stand Offs are hand-inspected to ensure quality and finish. We offer custom Stand Offs up to 5" in diameter. Black and custom colours are available.



## Wire and Rod Suspension Systems

The Wire Suspension and Rod Systems allow you to suspend panels or shelves from either vertical or horizontal wires or rods. Used together with the other Stand Off elements, you are able to build entire suspended panel systems for graphics, text or display purposes.

Like the Stand Offs, all the elements of these suspension systems are made of high quality, aircraft grade aluminum. They are machined, polished and anodized to perfection. The creative possibilities of these components are endless. We also offer assemblies that can be used in conjunction with all other parts and components.



## StructureLite

StructureLite is primarily a construction system that supports both the Stand Off and the Wire and Rod Suspension Systems. StructureLite Bars or Profiles are used with various assemblies and components to create an infinite variety of exhibit, display and furniture designs. Like the Stand Off and Wire and Rod Suspension systems, StructureLite components are of the highest quality and your satisfaction is assured. With the three systems, the possibilities are endless. If you can imagine it, you can build it with our systems.

## www.comsign.ca

- Photo gallery of applications
- On-line Catalogue
- Design information and specifications
- New products and news



## ***Frequently Asked Questions:***

***This is an overview of some Frequently Asked Questions. Please refer to our "General Terms and Conditions of Sale" for detailed information regarding our policies and terms.***

### ***What do you need to know in order to provide me with a quotation?***

The best way to provide you with an accurate quote, is for you to fax or e-mail us a drawing of your project. Even a rough sketch is very helpful. Include information about your panel material, size and thickness and the surface material you are fastening to.

Using this information, we will provide you with a detailed quotation including pricing and availability of the items.

### ***How long does it take to get a quote?***

Prices for individual parts by stock number are given the same day. Quotations involving intricate designs or large quantities are quoted within 2 working days. Quotations for custom manufactured or finished parts require 3+ working days.

### ***How do I place an order?***

In most cases, the ordering procedure is quite simple:

- 1) Fax, e-mail or phone us with your request.
- 2) We will check stock, generate a quotation and forward it to you by fax or e:mail.
- 3) Review the quotation. If everything is in order, return it to us with your signed acceptance. Include your credit card number, expiration date and the name on the card. Also provide shipping preference including your account number with the shipping carrier. **If you desire insurance on the shipment, be sure to indicate this in your acceptance. If there is no written request, we will ship un-insured.**
- 4) If all items are in stock and don't require custom cutting or threading, we will ship the same or next working day. Please indicate when you require the items.

### ***What are your terms?***

We require payment in full to be made with your order. Visa, Mastercard, money order, or cheque accepted. No shipments will be made until payment is received. Institutions and frequent buyers may apply for a charge account. Large orders and custom orders of any kind may require a deposit or payment in full even on account.

### ***Can I return items?***

**No Returns on custom ordered parts.**

Please see the "**General terms and Conditions of Sale**" for additional details of our return policy.

### ***How much weight will your components carry?***

Our parts are fabricated from aircraft grade aluminum and (or) stainless steel. They are sturdy and have been in use for many years in the field and in our showrooms. Proper installation is critical. It is the buyer's responsibility to make themselves aware of the installation site conditions and ensure that the parts can be mounted solidly and safely and are suited for the application.

***How long are your prices good for?***

Quotations are valid for 30 days from quotation date. All other price lists and verbal quotes are subject to change without notice. Prices will be confirmed at time of your order, and are FOB our warehouse in Edmonton. Special crating charges may apply to oversize or custom orders. This will be indicated on your quotation.

***What items do you stock in Edmonton?***

We are constantly expanding our selection of stocked items. Most items in our **Standard Stock Catalogue** are stocked in quantities of up to 300 pieces. Larger quantities or items from the **Full Line Catalogue** that are not in stock, are ordered from the manufacturer. It takes about **two** weeks to reach us by ground. **Expedited Service is available.**

***Can your parts be used outdoors?***

Since the parts are made of either anodized aluminum with a multi-coat protective finish or stainless steel, they can be safely used outdoors. Always use stainless steel fasteners and anchors for outdoor installations.

***Are colours available?***

The manufacturer stocks most of the items in this catalogue in anodized **Black and Custom Colours are available. Call for pricing and availability. It takes about two weeks to bring them in. Please call for pricing**

***Do you have any other parts available?***

There are many additional components in our **Master Catalogue**. This can be viewed online at **[www.comsign.ca](http://www.comsign.ca)**.

***I'm mounting glass. Are there any additional parts needed?***

Plastic tubing, and vinyl washers are recommended. Just let us know that you are mounting glass when you request a quote.

## We need to know...

- ① The desired standoff diameter from the catalogue and indicate **Regular** \_\_\_\_ or **Low Profile Cap** \_\_\_\_ (Please check one.)
- ② The thickness of your panel so we can provide the correct threaded stud length. ***If your panel is glass***, let us know so we can include the special inserts and washers required. Panels are Glass: **Yes** \_\_\_\_ **No** \_\_\_\_ (Please check one.)
- ③ The desired barrel length or part # from the catalogue.
- ④ The wall or base material that the barrel will be fastened to, ie: drywall, concrete, wood, etc. so we can determine the mounting fasteners required. (*Barrels have 5/16" female threads at bottom.*)
- ⑤ **Quantity** \_\_\_\_

***To be sure that you receive all the parts needed for your project, please copy this page, fill in the blanks, and fax it to us at 1-780-451-1012 for a quote and availability.***

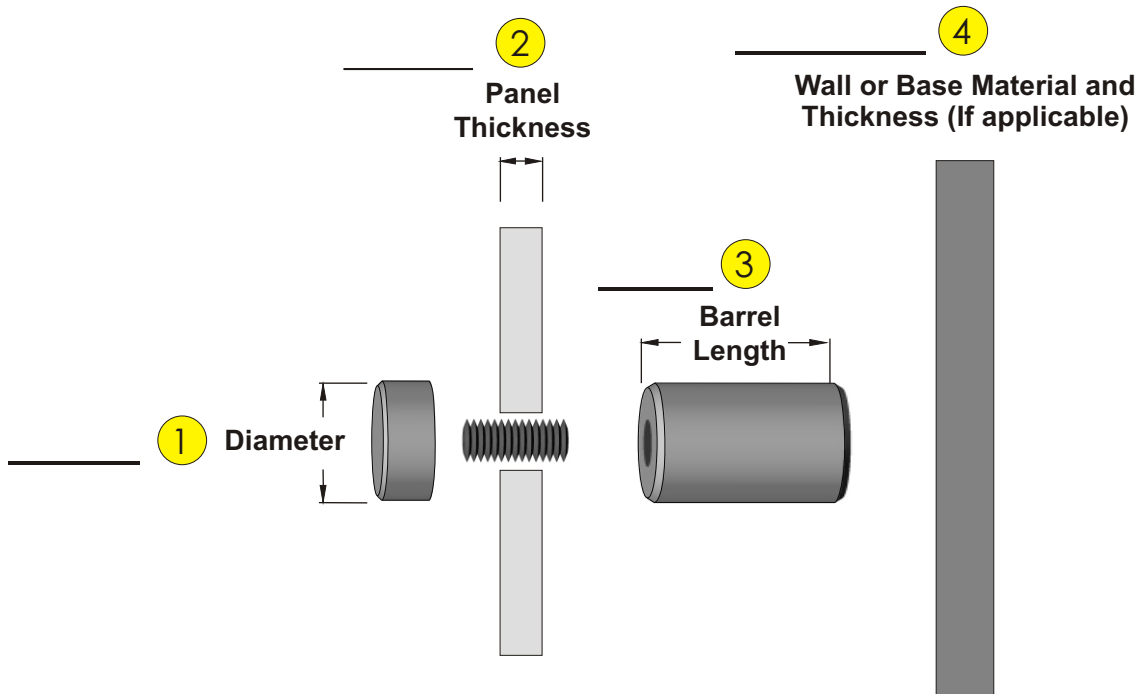

## Standard Cap

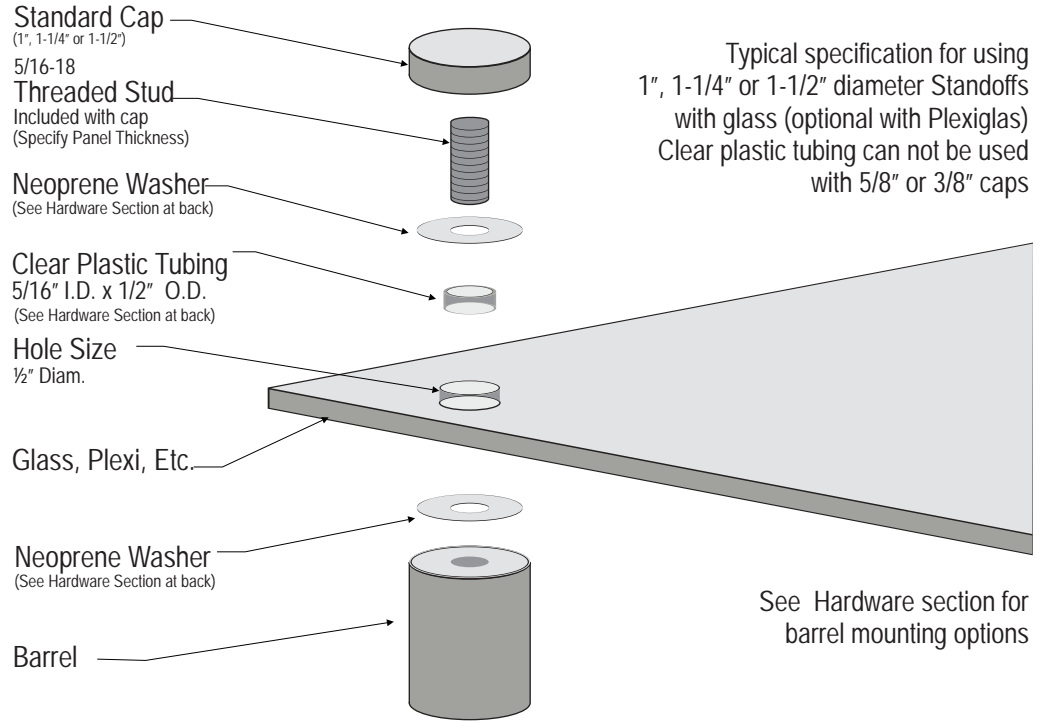

## Low Profile Cap

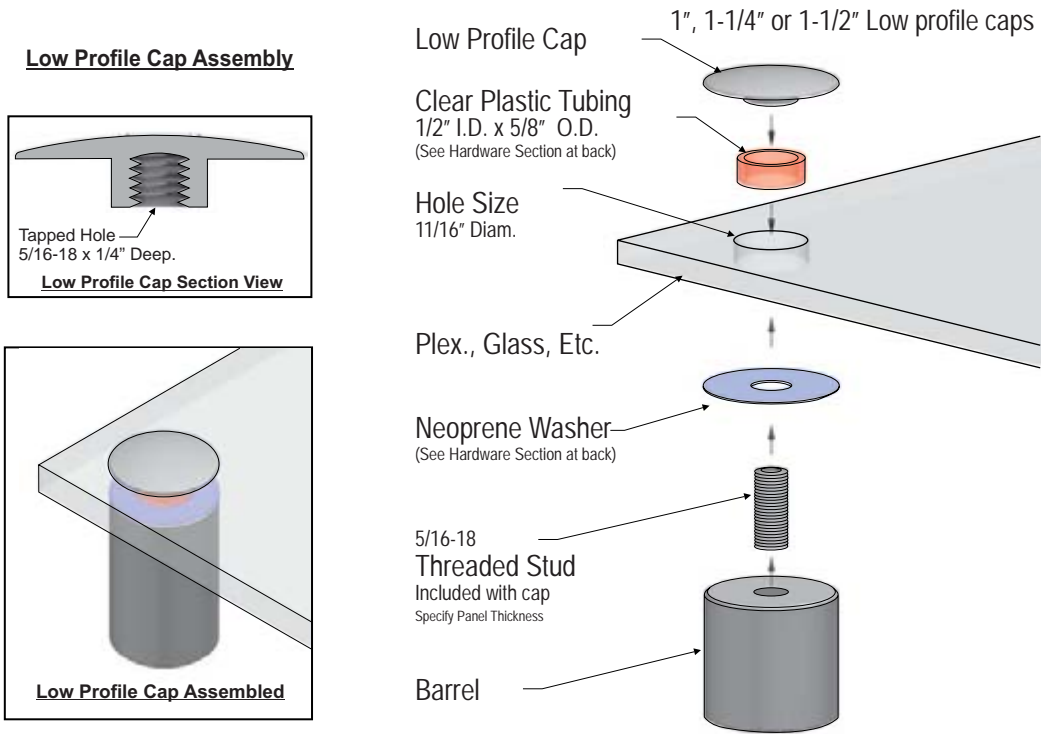



# General Terms and Conditions of Sale

## ***Important:***

The buyer's receipt of this acknowledgment without prompt written objection thereto shall constitute an acceptance by the buyer of all the terms and conditions set forth herein.

**1. Terms: Payment with order by Visa, MasterCard, Debit or Cheque.** Terms can be arranged for institutions or volume users.

**2. Freight Terms:** All shipments will be made via transportation company selected by customer or "best way" if not selected by customer. All freight charges are to be paid by customer either on customer's freight account or C.O.D.

**3. Merchandise Terms:** Title to all merchandise shall pass from Comsign Architectural Signage Inc. to the consignee upon delivery to the assigned transportation company. Acknowledgment has been made by the transportation company of the receipt in good condition of the material listed on the invoice or packing sheet. Claims for loss or damage on shipment must not be deducted from our invoice, nor payment of the invoice withheld awaiting adjustment of such claims. We do not guarantee safe delivery; that is the assigned transportation company's responsibility. Buyer grants seller a security interest in the goods to secure payment of the price in full together with a general power of attorney to execute and file, in the name of the buyer, a financing statement covering the goods sold by seller to buyers. Upon buyer's default in payment, seller may at its option repossess the goods and sell them.

**4. Claims Terms:** All claims for damage or incomplete shipment must be made within 48 hours after receipt of goods or it will be assumed shipment was without damage and complete. Comsign Architectural Signage Inc., or its agents assume no liability after this point. All claims for loss or damage in transit must be made by consignee to carrier. In no event shall seller be liable for incidental or consequential damages.

**5. Disclaimer of Warranty:** Seller makes no express or implied warranties, including, but not limited to, any implied warranty of merchantability or fitness for a particular purpose. Any use to which the goods are put would be subject to buyer's own testing and acceptance for purposes intended.

**6. Collection Cost:** In the event buyer defaults in the terms of payment, seller may recover from buyer all costs of collection, including without limitation reasonable attorney's fees, whether or not such collection includes commencement of a lawsuit.

**7. Return Merchandise Terms:** NO RETURNS AFTER 5 DAYS FROM RECEIPT. No merchandise may be returned without prior written authorization. Call for authorization and a "Returned Material Authorization Number" (RMA). All returns will be subject to a minimum **15% restocking charge**, except on products considered to be defective in workmanship and materials. No returns will be accepted unless shipped with the RMA number clearly shown on the outside shipping container.

**8. Pricing:** Prices are subject to change without notice. Merchandise will be shipped at prices prevailing at time of shipment. No price increases will be charged unless agreed to by customer prior to shipment.

**9. Product Warranty:** Comsign Architectural Signage Inc. warrants to the first purchaser that its products are free from defects in materials and workmanship. In the event of any defect, Comsign Architectural Signage Inc.'s sole obligation is expressly limited to repair or replacement, at our discretion, at Comsign Architectural Signage Inc.'s facility after written return authorization has been granted. In no event shall Comsign Architectural Signage Inc. under this warranty extend beyond the initial cost of the product and accordingly, any consequential damages arising out of a defect therein are expressly excluded. This warranty shall not apply to products which have been altered, improperly used or repaired outside of Comsign Architectural Signage Inc.'s facility nor shall it apply to defects for which written notice thereof is not received by Comsign Architectural Signage Inc. within ninety days from the date of purchase. This warranty is in lieu of all other warranties, expressed or implied, and without excluding the generality of the foregoing, excludes any implied warranty of merchantability.

**10. Law:** The laws of the province of Alberta shall govern the validity, construction and interpretation of the rights and duties of the parties defined in the terms and conditions of this agreement as stated.



	Part	Diameter	Length	Thread Size	Threading
1/4" dia.	SSO-2525	1/4"	3/16"	6-32	Drilled Thru - No Thread
3/8" dia.	SO-025	3/8"	1/4"	10-24	Drilled Thru - No Thread
	SO-050	3/8"	1/2"	10-24	Tapped Thru
	SO-010	3/8"	1"	10-24	1/2" Both Ends
5/8" dia.	EZ-SP1	5/8"	3/16"	5/16-18	Drilled Thru - No Thread
	SO-500	5/8"	1/2"	5/16-18	Tapped Thru
	SO-750	5/8"	3/4"	5/16-18	Tapped Thru
	SO-100	5/8"	1"	5/16-18	Tapped Thru
	SO-150	5/8"	1-1/2"	5/16-18	Tapped Thru
	SO-200	5/8"	2"	5/16-18	1" Both Ends
	SO-300	5/8"	3"	5/16-18	1" Both Ends
	SO-BAR5	5/8"	5-3/4"	5/16-18	1" Both Ends
	SO-BAR9	5/8"	9-3/4"	5/16-18	1" Both Ends
	SO-BAR11	5/8"	11-3/4"	5/16-18	1" Both Ends
3/4" dia.	SO-75075	3/4"	3/4"	5/16-18	Tapped Thru
	SO-75100	3/4"	1"	5/16-18	Tapped Thru
	SO-75125	3/4"	1-1/4"	5/16-18	Tapped Thru
1" dia.	SO-9025	1"	1/4"	5/16-18	Tapped Thru
	SO-9050	1"	1/2"	5/16-18	Tapped Thru
	SO-9100	1"	1"	5/16-18	Tapped Thru
	SO-9100CU	1"	1"	1/4-20	Tapped Thru
	SO-9150	1"	1-1/2"	5/16-18	Tapped Thru
	SO-9200	1"	2"	5/16-18	1" Both Ends
	SO-9300	1"	3"	5/16-18	1" Both Ends
	SO-9400	1"	4"	5/16-18	1" Both Ends
	SO-9600	1"	6"	5/16-18	1" Both Ends
1-1/4" dia.	SO-250	1-1/4"	1/4"	5/16-18	Tapped Thru
	SO-625	1-1/4"	5/8"	5/16-18	Tapped Thru
	SO-1	1-1/4"	1"	5/16-18	Tapped Thru
	SO-115	1-1/4"	1-1/2"	5/16-18	Tapped Thru
	SO-2	1-1/4"	2"	5/16-18	1" Both Ends
	SO-3	1-1/4"	3"	5/16-18	1" Both Ends
	SO-4	1-1/4"	4"	5/16-18	1" Both Ends
	SO-6	1-1/4"	6"	5/16-18	1" Both Ends
	SO-8	1-1/4"	8"	5/16-18	1" Both Ends
	SO-10	1-1/4"	10"	5/16-18	1" Both Ends
	SO-12	1-1/4"	12"	5/16-18	1" Both Ends
1-1/2" dia.	SO-1525	1-1/2"	1/4"	5/16-18	Tapped Thru
	SO-1505	1-1/2"	1/2"	5/16-18	Tapped Thru
	SO-151	1-1/2"	1"	5/16-18	Tapped Thru
	SO-152	1-1/2"	2"	5/16-18	1" Both Ends
	SO-153	1-1/2"	3"	5/16-18	1" Both Ends
	SO-154	1-1/2"	4"	5/16-18	1" Both Ends
2" dia.	SO-201	2"	1"	5/16-18	Tapped Thru
	SO-202	2"	2"	5/16-18	1" Both Ends
	SO-203	2"	3"	5/16-18	1" Both Ends
	SO-204	2"	4"	5/16-18	1" Both Ends
	SO-206	2"	6"	5/16-18	1" Both Ends



The 5/8" diameter barrels are available in a variety of lengths from 3/16" to 11-3/4"



The 1" diameter barrels compared with a 3/8" diameter barrel.



A 1-1/2" diameter barrel, 1/2" long.

Parts include everything shown unless otherwise noted.  
 Female caps come with your choice of stud lengths up to 1-1/2". Longer studs available at additional cost.

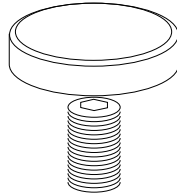

Standard Cap  
 With Removable Stud

Part	Diameter	Thread Size	Cap Height	Included
SO-CAP25	1/4"	6-32	5/32"	Hardware Sold Separately
SO-CAP7	3/8"	10-24	1/4"	Sold with stud up to 1-1/2"
SO-CAP8	5/8"	5/16-18	5/16"	Sold with stud up to 1-1/2"
SO-CAP75	3/4"	5/16-18	5/16"	Sold with stud up to 1-1/2"
SO-CAP9	1"	5/16-18	3/8"	Sold with stud up to 1-1/2"
SO-CAP3	1-1/4"	5/16-18	1/2"	Sold with stud up to 1-1/2"
SO-CAP10	1-1/2"	5/16-18	1/2"	Sold with stud up to 1-1/2"
SO-CAP22	2"	5/16-18	5/8"	Sold with stud up to 1-1/2"

Low Profile Caps on Page 4



The Aluminum Round Caps are available in a variety of diameters.

Parts include everything shown unless otherwise noted.  
 Female caps come with your choice of stud lengths up to 1-1/2". Longer studs available at additional cost



SO-CAP20

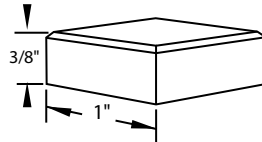

**1" Wide Square Cap**  
 (Specify panel thickness when ordering)  
 5/16-18 thread

Part	Cap Height	Stud Length
SO-CAP20	3/8"	Specify *

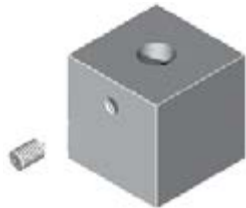

SO-ASQ1 & 2

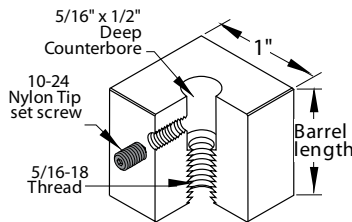

**1" Wide Square Barrels**

Part	Length	Tapped
SO-ASQ1	1"	1/2" one end
SO-ASQ2	2"	1" one end

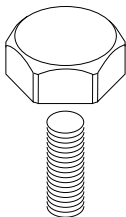

SO-HCAP1

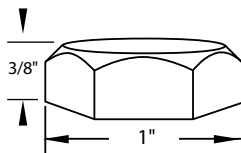

**1" Wide Hex Cap**  
 (Specify panel thickness when ordering)  
 5/16-18 thread

Part	Cap Height	Stud Length
SO-HCAP1	3/8"	Specify *

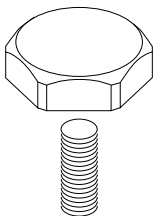

SO-HCAP2

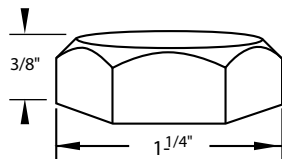

**1-1/4" Wide Hex Cap**  
 (Specify panel thickness when ordering)  
 5/16-18 thread

Part	Cap Height	Stud Length
SO-HCAP2	3/8"	Specify *

Parts include everything shown unless otherwise noted.

\* Female caps come with your choice of stud lengths up to 1-1/2". Longer studs available at additional cost.

## ONE PIECE CAPS WITH FIXED STUD



Part	Diameter	Thread Size	Cap Height	Stud Length
SO-CAP17	3/8"	10-24	1/8"	1/2" Fixed
SO-CAP18	5/8"	5/16-18	1/8"	1/4" Fixed
SO-CAP19	5/8"	5/16-18	1/8"	5/8" Fixed

## LOW PROFILE CAP WITH STEM AND REMOVABLE STUD

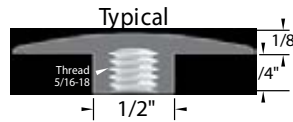

Part	Diameter	Thread Size	Cap Height	Stud Length	Included
SO-CAP11	1"	5/16-18	1/8"	Specify	Sold with stud up to 1-1/2"
SO-CAP12	1-1/4"	5/16-18	1/8"	Specify	Sold with stud up to 1-1/2"
SO-CAP13	1-1/2"	5/16-18	1/8"	Specify	Sold with stud up to 1-1/2"
SO-CAP23	2"	5/16-18	1/8"	Specify	Sold with stud up to 1-1/2"
SO-CAP14	2-1/2"	5/16-18	1/8"	Specify	Sold with stud up to 1-1/2"

Minimum material thickness for the shoulder of these caps is 1/4". Specify panel thickness when ordering.

TOOLS FOR LOW PROFILE CAPS	
HD-NW	For caps 11, 12, 13, 14 & 23
HD-AD2	3/32" Hex Tool for Caps 17, 18 & 19
HD-AW2	3/32" Allen Wrench for Caps 17 & 18

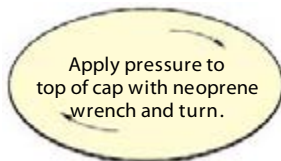

HD-NW



HD-AD2



HD-AW2

Parts include everything shown unless otherwise noted.  
Cup Point set screw and 5/16-18 fastener included. Nylon Tip set screw optional for glass, and other materials.

SO-AGR-250

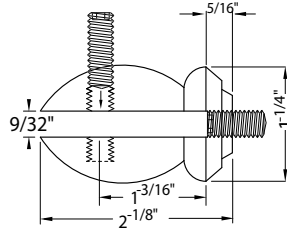

**1/4" Gripper**  
(Specify material & application)  
Includes 5/16-18 x 3/4" Stud

Part	Holds
SO-AGR-250	1/4"

SO-AGR-375

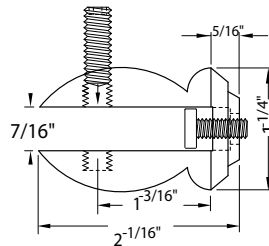

**3/8" Gripper**  
(Specify material & application)  
Includes 5/16-18 x 1/2" Low Head

Part	Holds
SO-AGR-375	3/8"

SO-AGR-500

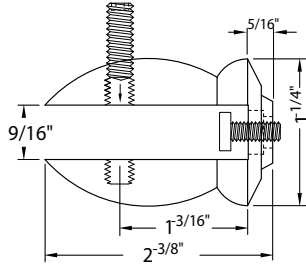

**1/2" Gripper**  
(Specify material & application)  
Includes 5/16-18 x 1/2" Low Head

Part	Holds
SO-AGR-500	1/2"

SO-AGR-750

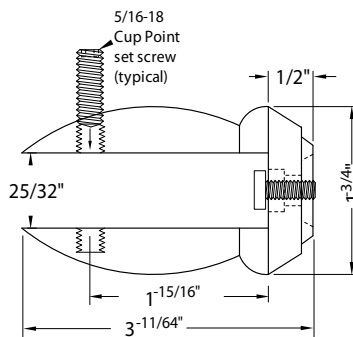

**3/4" Gripper**  
(Specify material & application)  
Includes 5/16-18 x 1/2" Low Head

Part	Holds
SO-AGR-750	3/4"



SO-AGR-250 Thru 750WMBT

**Gripper Assemblies**  
(Specify material & application)  
Includes Low Head & (3) Mounting Screws  
Wall plate is 2-1/4" diameter x 1/4" thick

Part	Holds
SO-AGR-250WMBL	1/4"
SO-AGR-375WMBT	3/8"
SO-AGR-500WMBT	1/2"
SO-AGR-750WMBT	3/4"

Note: Specify the surface that the Gripper will be mounted to, and what panel material will be used.

Parts include everything shown unless otherwise noted.

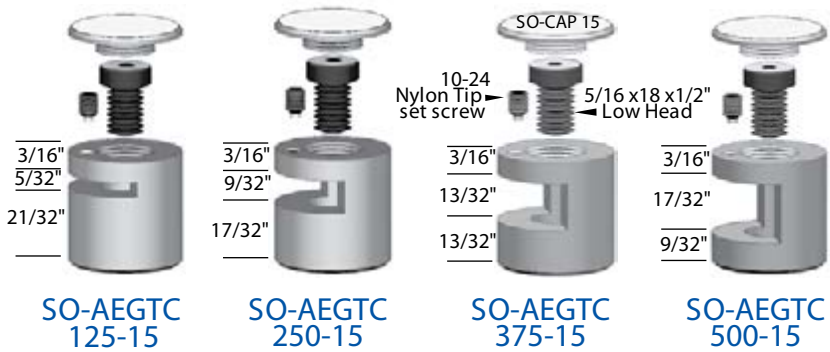

### 1" Diameter EdgeGrips with Threaded Caps

Includes Set Screw, Low Head, and cap for mounting

Part	Holds	Overall Height
SO-AEGTC125-15	1/8"	1-1/16"
SO-AEGTC250-15	1/4"	1-1/16"
SO-AEGTC375-15	3/8"	1-1/16"
SO-AEGTC500-15	1/2"	1-1/16"

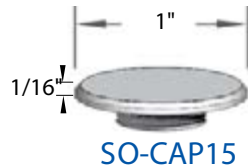

### Cap for use with 1" dia. EdgeGrips

Part	Threading
SO-CAP15	1/2-20

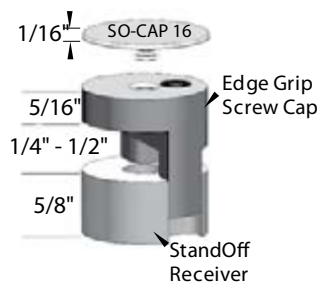

### 1-1/4" Diameter Adjustable EdgeGrips

Includes Adjustment Screw, Low Head and & Cap for mounting

Part	Holds	Overall Height
SO-AEGSC16	1/4" - 1/2"	1-1/4" - 1-1/2"

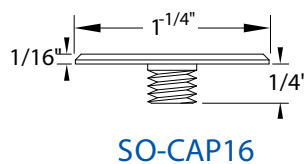

### Cap for use with 1-1/4" dia. EdgeGrips

Part	Threading
SO-CAP16	5/16-18

Parts include everything shown unless otherwise noted.

SO-APC-100

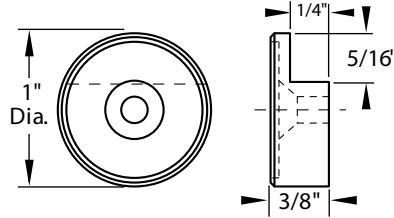

SO-APC-125

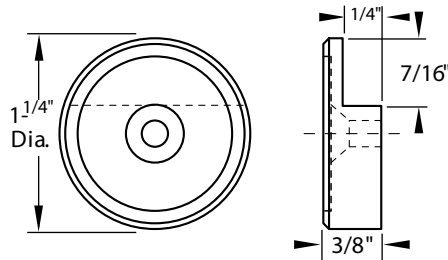

### Flush-Mount PANEL CLIPS

Includes: Panel Clip, Cap Disc, #8 Mounting Screw, Anchor and 2 Shims

Part	Diameter	Holds
SO-APC-100	1"	1/8", 3/16" & 1/4"
SO-APC-125	1-1/4"	1/8", 3/16" & 1/4"



SO-APEG9

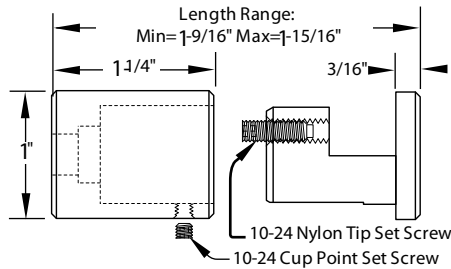

### ADJUSTABLE PANEL EDGE GRIPS

Includes Set Screws as shown

Part	Diameter	Holds
SO-APEG9	1"	1/8" to 1/2"
SO-APEG3	1-1/4"	1/8" to 3/4"

SO-APEG3

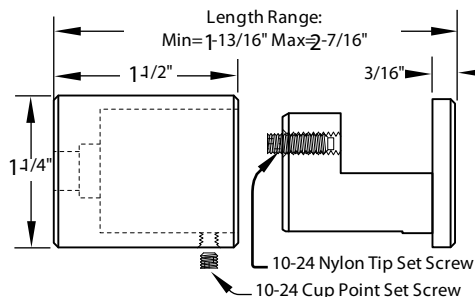

Parts include everything shown unless otherwise noted.  
Wire Suspension parts are for use with 3/64" WS-Wire, (wire sold separately).

### WS-WIRE



### 3/64" Stainless Steel Wire

There are NO returns allowed on wire

Part	Strands	Diameter
WS-WIRE	1x19	3/64"

### WS-AVWC

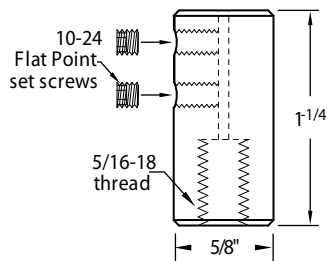

### Vertical Wire Connector

Part  
WS-AVWC

### WS-A17-125 thru 500



### Vertical Connector & Shelf Clip

Part	Holds	Slot Width
WS-A17-125	1/8" material	.155
WS-A17-250	1/4" material	.265
WS-A17-375	3/8" material	.385
WS-A17-500	1/2" material	.515

### WS-ATVWC

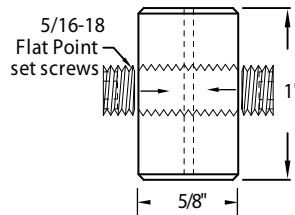

### Traveling Vertical Wire Connector

Part  
WS-ATVWC

### WS-A14

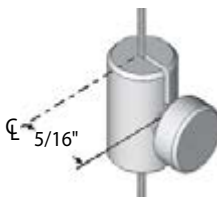

### Traveling Vertical Wire Connector & Cap 8

(Specify panel thickness when ordering)

Part	Stud Length
WS-A14	Specify*



Parts include everything shown unless otherwise noted.  
Wire Suspension parts are for use with 3/64" WS-Wire, (wire sold separately).

### WS-ASC-125

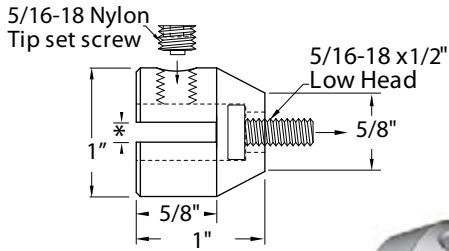

### WS-ASC-250

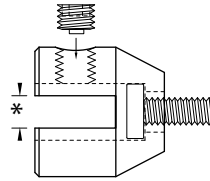

WALL MOUNT BRACKET  
AVAILABLE

### Shelf Clips

Part	Holds	Slot Width
WS-ASC-125	1/8" panel	.185
WS-ASC-250	1/4" panel	.265
WS-ASC-375	3/8" panel	.385
WS-ASC-500	1/2" panel	.515

### WS-ASC-375

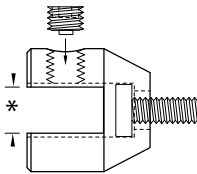

\* See chart for sizes

### WS-ASC-500

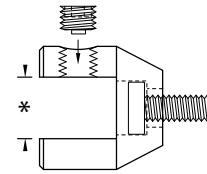

### WS-AHWC1

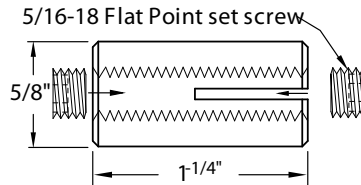

### Horizontal Wire Connectors

Part	Type
WS-AHWC1	Type 1
WS-AHWC2	Type 2

### WS-AHWC2

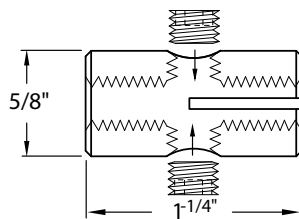

### WS-A23

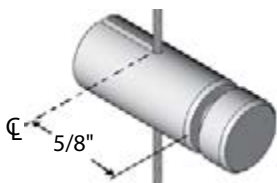

### Horizontal Wire Connector 1 & Cap 8

(Specify panel thickness when ordering)

Part	Stud Length
WS-A23	Specify*

Parts include everything shown unless otherwise noted.  
Wire Suspension parts are for use with 3/64" WS-Wire, (wire sold separately).

### WS-A25

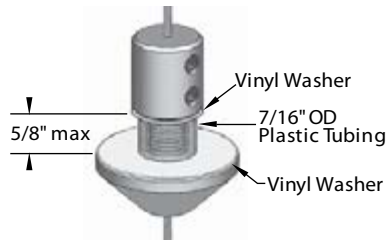

**Shelf Hub Assembly**  
(Specify panel thickness when ordering)

Part	Panel thickness	Stud Length
WS-A25	Max. 5/8"	Specify*

### WS-ATWCRH

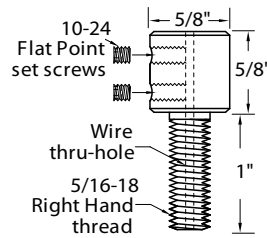

**Threaded Wire Connector**  
WS-ATWCRH wire hole passes completely through

Part  
WS-ATWCRH Right Hand Threads  
WS-ATWCLH Left Hand Threads

### WS-ATWCLH

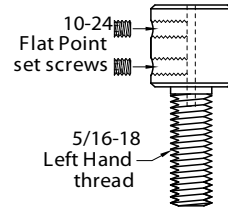

### WS-ASH

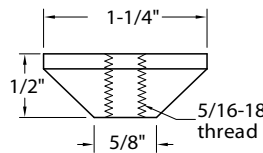

**Shelf Hub**  
Used as wall plates and shelf holders

Part  
WS-ASH

### WS-ATB

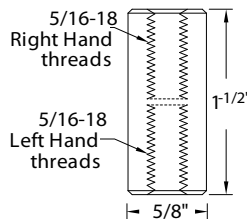

**Turnbuckle**  
Right hand threads in one end, left hand threads in the other

Part  
WS-ATB

### WS-A16

Min length 3-3/8"  
Max length 4-3/8"



**Flying Turnbuckle Assembly**  
Used to tension wire

Part  
WS-A16

Total Travel
1" extended to closed

Parts include everything shown unless otherwise noted.  
Wire Suspension parts are for use with 3/64" WS-Wire, (wire sold separately).

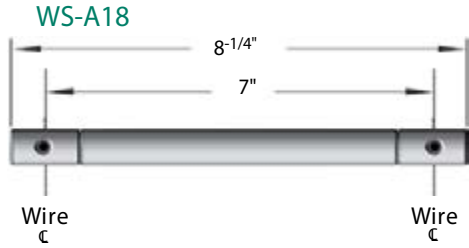

### Wire Spreader Bar

Part	Bar	Total Assy.Length
WS-A18	5-3/4" x 5/8"	8-1/4"
WS-A19	9-3/4" x 5/8"	12-1/4"
WS-A20	11-3/4" x 5/8"	14-1/4"

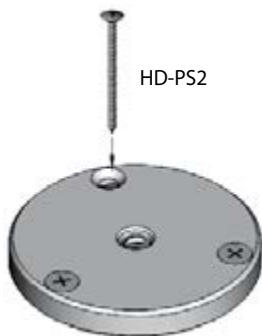
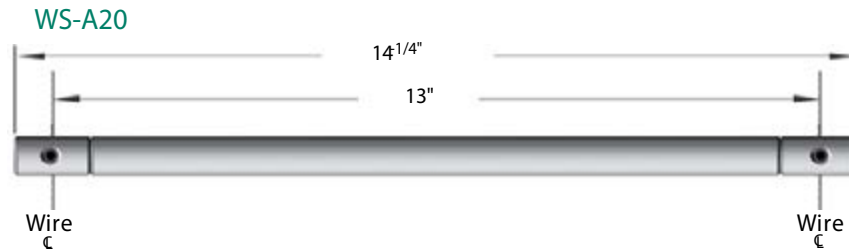
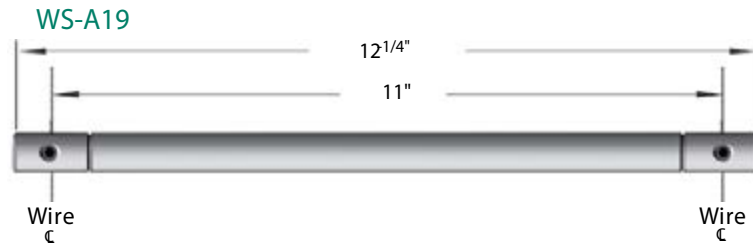

HD-PS2

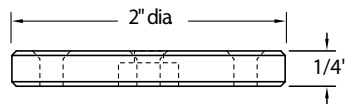

WS-AWMBL

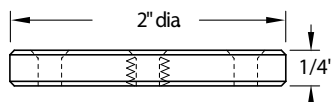

WS-AWMBT

**Wall Mount Brackets**  
Includes 3, #8 x 1-1/2" long  
(HD-PS2) mounting screws

Part	Center Hole
WS-AWMBL	Counterbore
WS-AWMBT	5/16-18 Threaded Thru

Parts include everything shown unless otherwise noted.  
Wire Suspension parts are for use with 3/64" WS-Wire, (wire sold separately).

WS-APHF

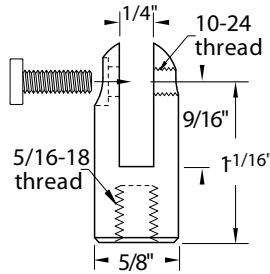

Pulley Holder Female

Part

WS-APHF

WS-APWCF

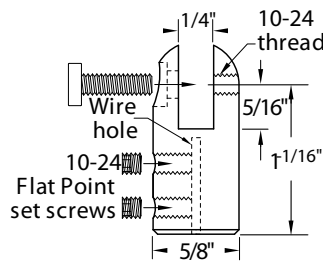

Pulley Wire Connector Female

Part

WS-APWCF

WS-APHMR

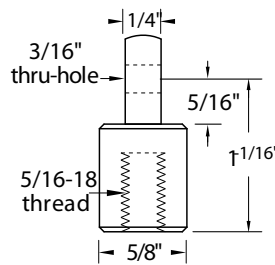

Pulley Holder Male

Part

WS-APHMR

WS-APWCM

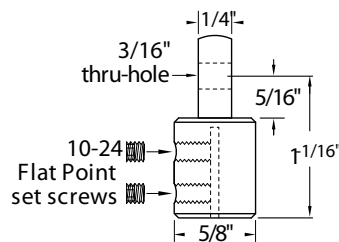

Pulley Wire Connector Male

Part

WS-APWCM

Parts include everything shown unless otherwise noted.  
Wire Suspension parts are for use with 3/64" WS-Wire, (wire sold separately).

### WS-AWSC-250 thru 500

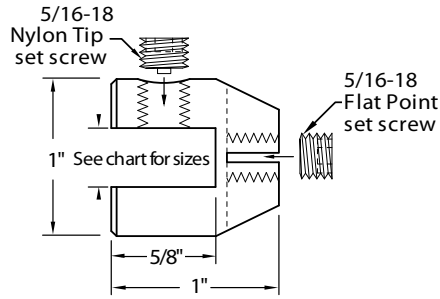

### Wire Shelf Clips

Part	Holds	Slot Width
WS-AWSC-250	1/4" panel	.280
WS-AWSC-375	3/8" panel	.405
WS-AWSC-500	1/2" panel	.530

Note: May be used for vertical or horizontal applications.

### WS-A1WHW

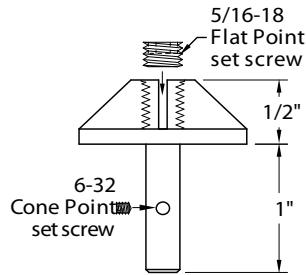

### 1 Way Hub w/Wire Slot

Part	Holds
WS-A1WHW	WS-Wire

Note: Used with StructureLite Profiles (see StructureLite Catalog)

### WS-A10



### Wheel Assembly

Part  
WS-A10

Note: Extruded profiles sold separately (see StructureLite Catalog)

### WS-AEHG-250

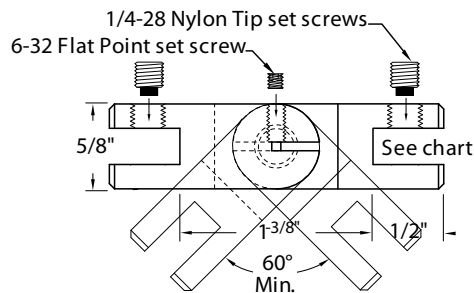
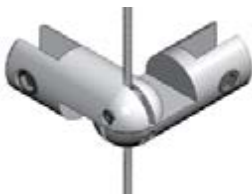

### Econo Hinge Gripper

Part	Holds	Slot Width
WS-AEHG-250	1/4" panel	.265

Parts include everything shown unless otherwise noted.  
Wire Suspension parts are for use with 3/64" WS-Wire, (wire sold separately).

**WS-AHEG-250**

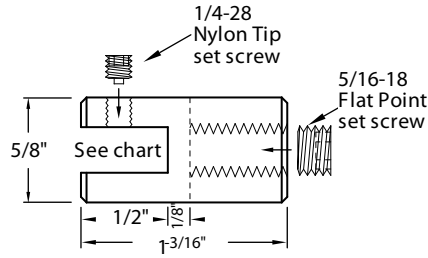

### Horizontal Econo Gripper

Part	Holds	Slot Width
WS-AHEG-250	1/4" panel	.265

**WS-AEVG-125 & AEVG-250**

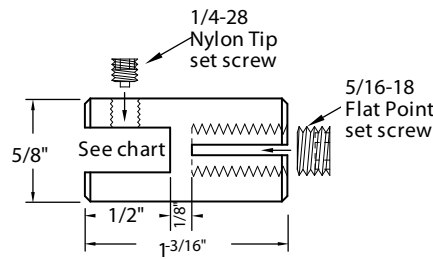

### Econo Vertical Grippers

Part	Holds	Slot Width
WS-AEVG-125	1/8" panel	.185
WS-AEVG-250	1/4" panel	.265

**WS-AEVDG-125**

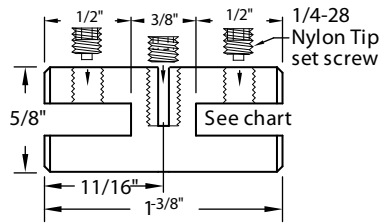

### Econo Vertical Double Grippers

Part	Holds	Slot Width
WS-AEVDG-125	1/8" panel	.185
WS-AEVDG-250	1/4" panel	.265

**WS-AEVDG-250**

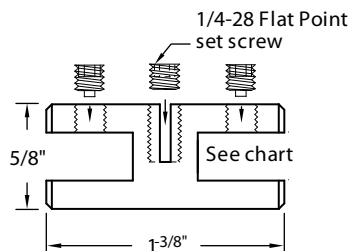

Parts include everything shown unless otherwise noted.  
Wire Suspension parts are for use with 3/64" WS-Wire, (wire sold separately).

**WS-AESG-125**

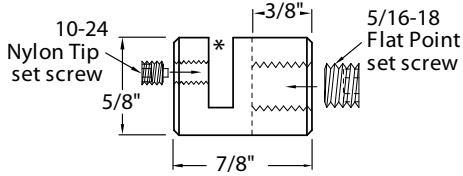

**WS-AESG-250**

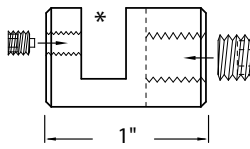

\* See chart for size



### Econo Saddle Grippers

Part	Holds	Slot Width
WS-AESG-125	1/8" panel	.155
WS-AESG-250	1/4" panel	.288
WS-AESG-375	3/8" panel	.405
WS-AESG-500	1/2" panel	.530

**WS-AESG-375**

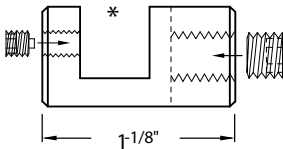

**WS-AESG-500**

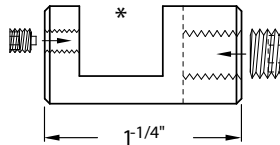

**WS-AEPG-125**

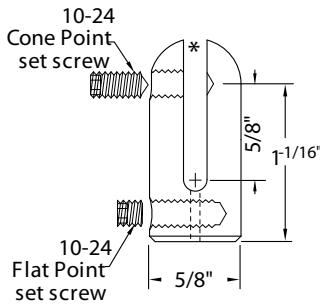

\* See chart for size

### Econo Panel Grippers

Part	Holds	Slot Width
WS-AEPG-125	1/8" panel	.155
WS-AEPG-250	1/4" panel	.265

**WS-AEPG-250**

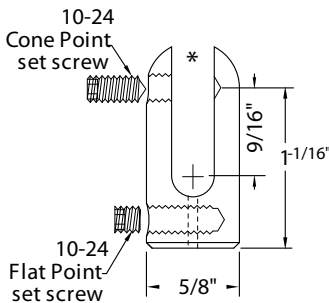

Parts include everything shown unless otherwise noted.  
Wire Suspension parts are for use with 3/64" WS-Wire, (wire sold separately).

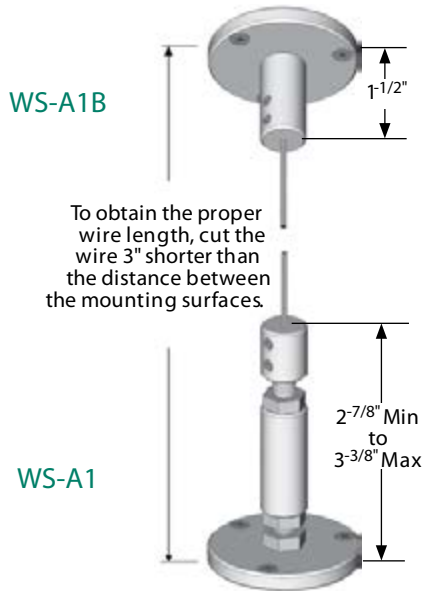

### Threaded Wire Connector, Turnbuckle & Wall Mount Bracket Assemblies

Includes  
3, #8 x 1-1/2" long (HD-PS2) Mounting Screws

Part	Mount
WS-A1B	Upper Mount
WS-A1	Lower Mount

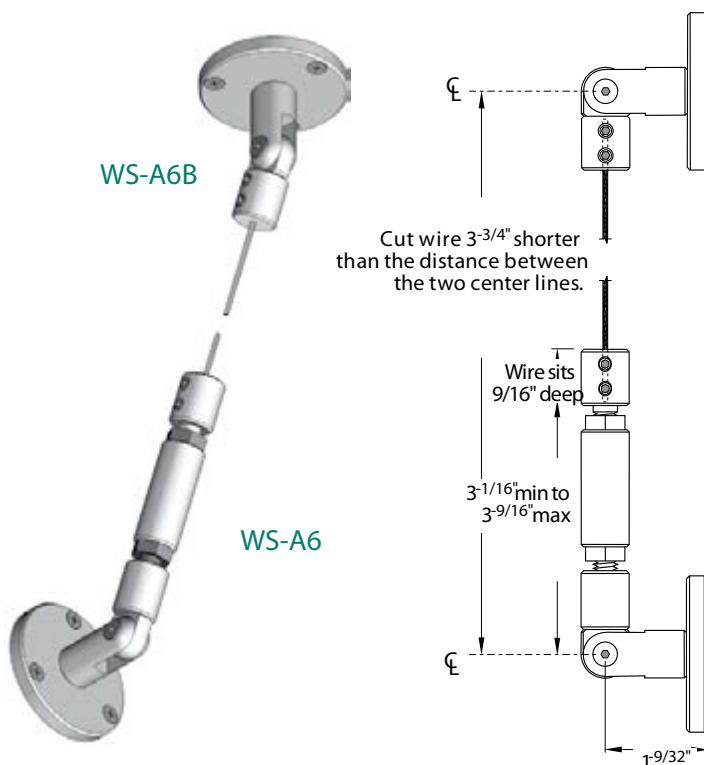

### Threaded Wire Connector, Turnbuckle, Pulley Hinge & Wall Mount Bracket Assemblies

Includes  
3, #8 x 1-1/2" long (HD-PS2) Mounting Screws

Part	Mount
WS-A6B	Upper Mount
WS-A6	Lower Mount



Parts include everything shown unless otherwise noted.  
 Wire Suspension parts are for use with 3/64" WS-Wire, (wire sold separately).

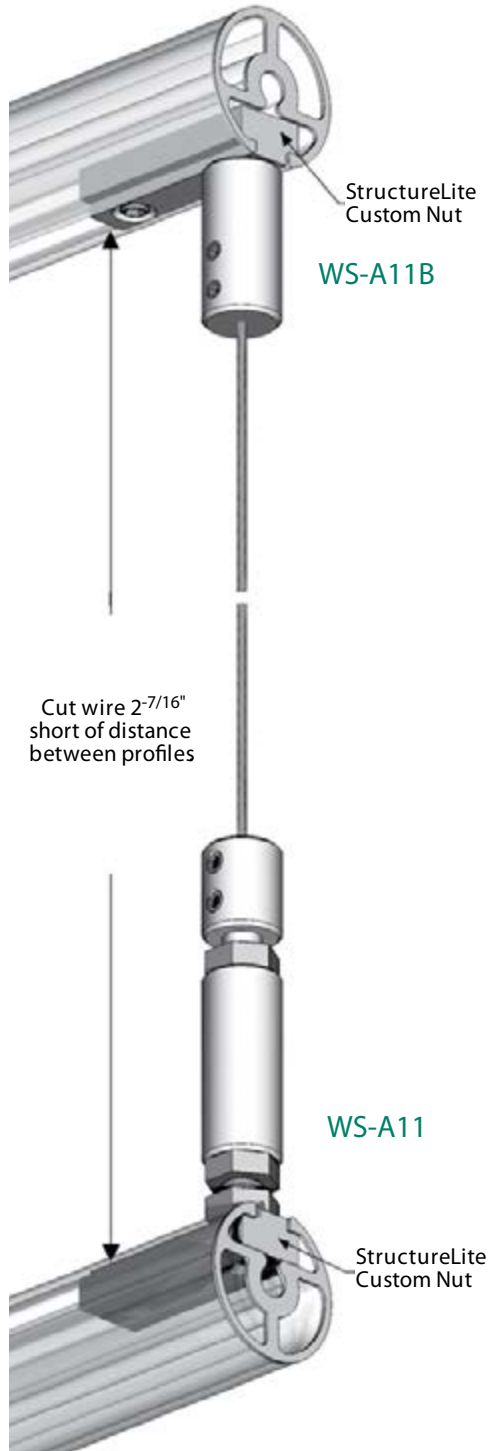

### Threaded Wire Connector, Turnbuckle & Custom Nut Assemblies

Note: StructureLite profiles sold separately.

**Part**

- WS-A11B      Upper Mount
- WS-A11       Lower Mount



Rod Suspension components and assemblies are available, please contact us if you need more information. (1-888-452-9019)



# StructureLite Display Components

StructureLite



A wide range of extrusions, hinges and display components are available please contact us if you need more information. (1-888-452-9019)

### Cup Point Socket Set Screws Stainless Steel

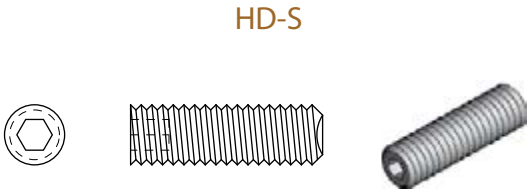

Part	Thread Size	Thread Length	Drive Style
HD-S1	10-24	1/8"	3/32" Hex Head
HD-S2	10-24	1/4"	3/32" Hex Head
HD-S3	10-24	1/2"	3/32" Hex Head
HD-S4	10-24	5/8"	3/32" Hex Head
HD-S5	10-24	3/4"	3/32" Hex Head
HD-S6	10-24	7/8"	3/32" Hex Head
HD-S7	10-24	1"	3/32" Hex Head
HD-S8	10-24	1-1/4"	3/32" Hex Head

HD-S14	5/16-18	1/4"	5/32" Hex Head
HD-S15	5/16-18	3/8"	5/32" Hex Head
HD-S16	5/16-18	1/2"	5/32" Hex Head
HD-S17	5/16-18	5/8"	5/32" Hex Head
HD-S18	5/16-18	3/4"	5/32" Hex Head
HD-S19	5/16-18	7/8"	5/32" Hex Head
HD-S20	5/16-18	1"	5/32" Hex Head
HD-S205	5/16-18	1-1/8"	5/32" Hex Head
HD-S21	5/16-18	1-1/4"	5/32" Hex Head
HD-S22	5/16-18	1-1/2"	5/32" Hex Head
HD-S23	5/16-18	1-3/4"	5/32" Hex Head
HD-S24	5/16-18	2"	5/32" Hex Head

HD-AW1 HD-AW2 HD-AW3 HD-AW4



### Hex Key Wrenches

Part	Size
HD-AW1	1/16"
HD-AW2	3/32"
HD-AW3	1/8"
HD-AW4	5/32"
HD-AWS	.050 to 3/16"



### Driver Bit

Part	Size
HD-AD4	5/32" Hex Shank



### Wood Mount Hanger Screws & Drivers

Part	Machine Thread x Length	Overall Length	Pre-drill
HD-WHS1	10-24 x 5/8"	1-1/2"	1/8"
HD-WHS3	5/16-18 x 9/16"	1-1/2"	1/4"
HD-WHS4	5/16-18 x 1"	2-1/2"	1/4"
HD-WHS5	5/16-18 x 2"	4-1/4"	1/4"

HD-WHSD1	Driver for 10-24
HD-WHSD2	Driver for 5/16-18

### IMPORTANT

These HOW TO instructions are GUIDELINES ONLY. Your installation may be different from those shown here. NO SAFETY GUARANTEE is expressed or implied in any installation done by purchaser.

It is the responsibility of the INSTALLER and/or END USER to ensure that the parts and materials used in any installation are specified and engineered to meet the demands of their intended purpose.

Call 1-888-452-9019 to speak with our knowledgeable Client Solutions Specialists about your installation.

### Wood Mount Hanger Screws

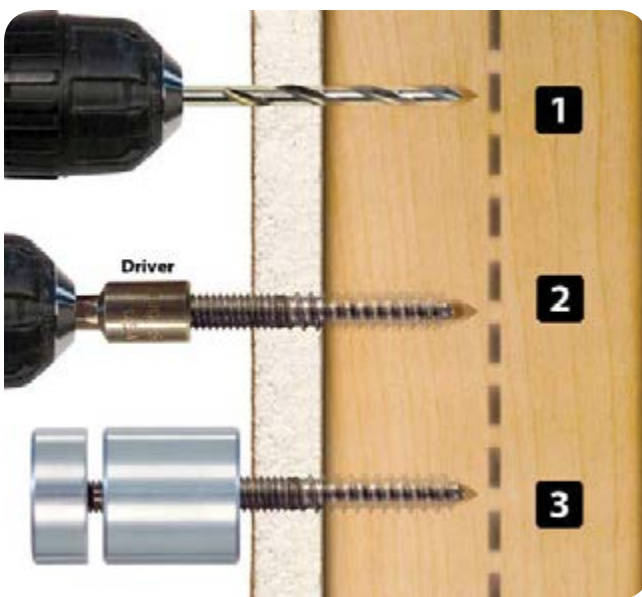

(1) Pre-drill the proper pilot hole size into wood surface using the chart shown above.

(2) To install the hanger screw, we recommend two options.

**Option A:** If only a few need to be installed, we recommend using two hex jam nuts to use as a tool to wrench and tighten into surface.

**Option B:** Purchase a stud driver for the correct thread size (see above)

**TIP:** Apply candle wax or bar of soap onto anchor to help with installing and/or removing it from wall surface.

Be sure to leave the desired thread length exposed from the wall surface needed to attach parts. Once installed, remove the hex jam nuts or driver from anchor.

(3) Attach the appropriate parts for your application.



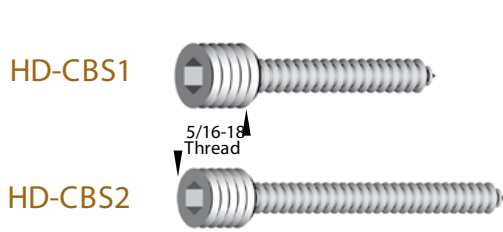

### Combination Screws #8 screw to 5/16-18 threads

Part	Thread x Length	Overall Length	Drive Style
HD-CBS1	5/16-18 x 5/16"	1-1/2"	5/32" Hex Head
HD-CBS2	5/16-18 x 5/16"	2"	5/32" Hex Head

CAN BE DRIVEN DIRECTLY INTO WOOD OR ANY #8 ANCHOR



### Driver Bit

Part	Size
HD-AD4	5/32" Hex Shank

### IMPORTANT

These HOW TO instructions are GUIDELINES ONLY. Your installation may be different from those shown here. NO SAFETY GUARANTEE is expressed or implied in any installation done by purchaser.

It is the responsibility of the INSTALLER and/or END USER to ensure that the parts and materials used in any installation are specified and engineered to meet the demands of their intended purpose.

Call 1-888-452-9019 to speak with our knowledgeable Client Solutions Specialists about your installation.

### HD-CA4 Concrete Anchor

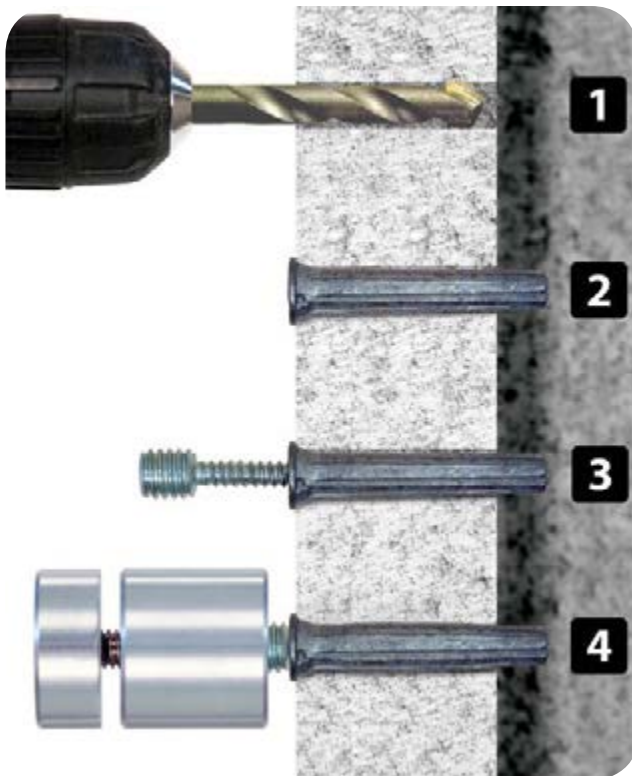

(1) With a masonry bit, pre-drill a 1/4" diameter hole x 1-1/2" deep in concrete, cinder block or other masonry surface.

(2) With a hammer, lightly tap the lead anchor into the surface until the head is as flush as possible. Be careful not to deform the metal anchor or wall surface.

(3) Screw the appropriate #8 Screw or Combination Screw into the center of the installed anchor.

(4) Attach the desired needed for the application to complete the assembly.



### Self-Drilling Wallboard Anchors

Part	Thread Size	Thread Length	Drive Style
HD-WBL	#8	9/64"	Phillips Head
HD-WBSA	#8	9/64"	Phillips Head
HD-WB2	5/16-18	5/16"	5/32" Hex Head

### Driver Bit for HD-WB2

Part	Size
HD-AD4	5/32" Hex Shank

### HD-WBL Self-Drilling Wallboard Anchors

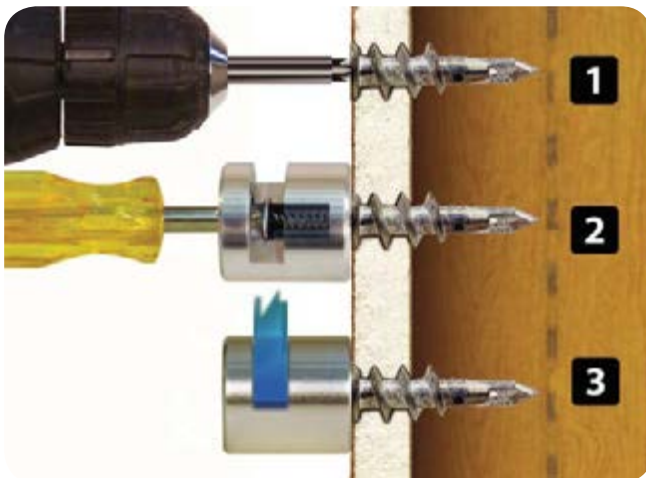

(1) With a Phillips Bit, self-drill the anchors into position.  
**NOTE:** *These anchors are not intended for wood or other dense materials. Intended for 1/2" or thicker drywall.*

(2) Insert the #8 screw into the installed anchor and tighten.

(3) When fully tightened, attach the parts needed for your application.

*For part numbers HD-WBSA, that utilize HD-WBL.*



**H**

## 10-24 Toggle Bolt Anchor

STOCK#  
HD-TWA2

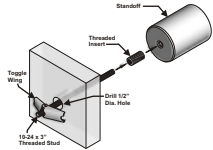

Assembly includes: 10-24 Toggle Wing, 10-24 to 5/16-18 x 1/2" Threaded Insert, 10-24 x 3" Stud.

Suitable for 7/8" or larger diameter barrels.

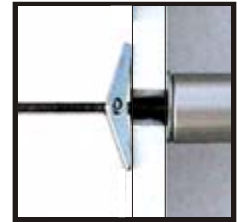

**I**

## 5/16-18 Toggle Bolt Anchor

STOCK#  
HD-TWA1

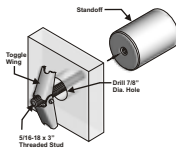

Assembly includes: 5/16" Toggle Wing, 5/16-18 x 3" Stud

Suitable for 1-1/4" or larger diameter barrels.

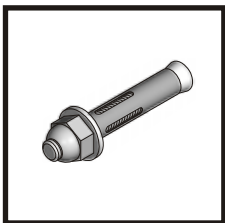
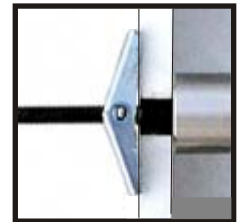

**J**

## Concrete Wedge Anchors

STOCK#	THREAD SIZE
HD-CA2	10-24
HD-CA3	5/16-18

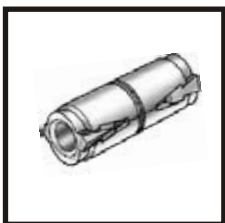
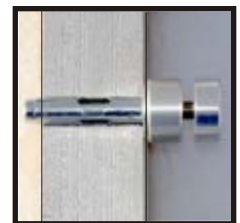

**K**

## Concrete Nut Insert

STOCK#	THREAD SIZE
HD-CA1	5/16-18

For Installation of 5/16" thread in concrete

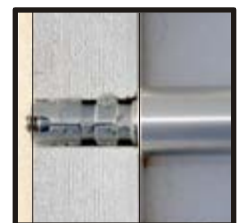



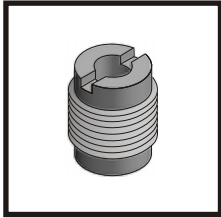

## Threaded Knife Edge Wood Inserts

STOCK#	INTERNAL THREAD SIZE	DEPTH
HD-WI1	10-24	1/2"
HD-WI3	5/16-18	5/8"

*Inserted into wood to provide for attachment of components with 5/16-18 threaded fasteners*

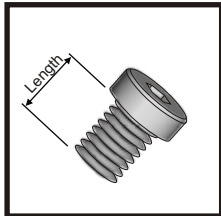

## Low Head Socket Cap Screw

STOCK#	THREAD SIZE	LENGTH
HD-LHD7	5/16-18	3/8"
HD-LHD8	5/16-18	1/2"
HD-LHD9	5/16-18	3/4"
HD-LHD10	5/16-18	1"
HD-LHD11	5/16-18	1-1/4"
HD-LHD12	5/16-18	1-1/2"
HD-LHD14	5/16-18	2"

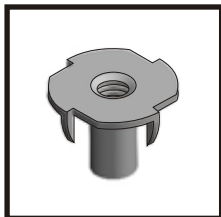
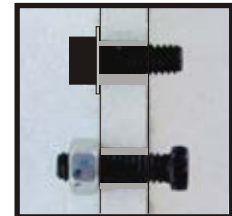

## T-Nuts

STOCK#	THREAD	DEPTH
HD-WTN1	10-24	3/8"
HD-WTN3	5/16-18	7/16"

*Used to provide threads in wood or plastic when access to the back side of the panel is available*

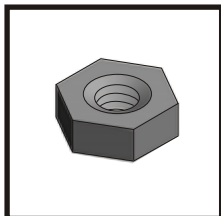
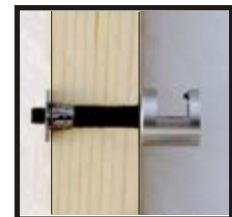

## 5/16-18 Hex Jam Nut

STOCK#  
HD-HJN3

*Can be used on any of the parts with a 5/16-18 male thread*



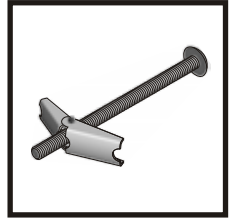

P

10-24 x 3" Pan Head Machine Screw into Small Toggle Assembly

STOCK#  
HD-TWA3

*Used to fasten edge grips and grippers to hollow walls*

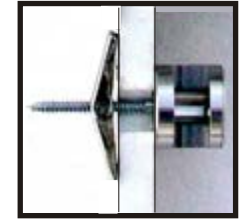

Q

Flat Washer Head Screw

STOCK#	LENGTH
HD-PS4	1-1/4"
HD-PS5	2"

*#8 Thread for mounting edge grips and grippers directly to wood, sheet metal and other substrates, or used in conjunction with standard wall anchors*

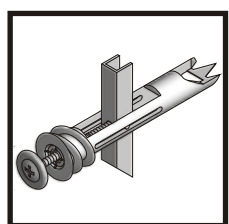

R

2" Long Self Tapping Screw into Self Drilling Toggle

STOCK#  
HD-STB

*For installation of components onto wallboard.*

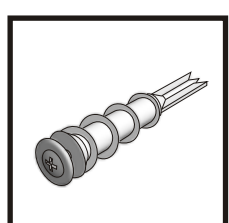
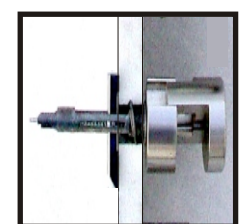

S

1" Long Self Tapping Screw into Self Drilling Wallboard Anchor

STOCK#  
HD-WBSA

*For installation of components onto wallboard.*

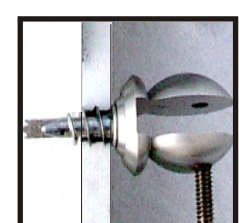



### Plastic Wall Anchor

STOCK#  
HD-PA

*Used as an anchor in concrete or stucco where a #8 threaded fastener is used.*

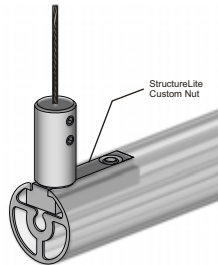
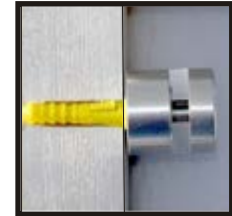

### StructureLite Custom Nut

STOCK #  
SL-CNRH

*Used to connect components with 5/16-18 threads to various 1-1/4" diam. StructureLite tubing profiles.*

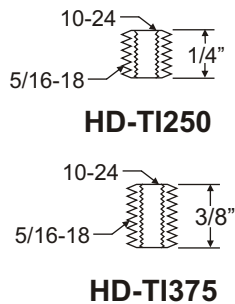
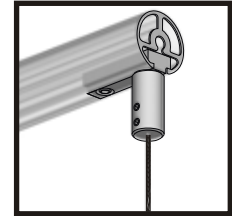

### Aluminum Threaded Inserts

STOCK#	EXT. THREAD	INT. THREAD	LENGTH
HD-TI250	5/16-18	10-24	1/4"
HD-TI375	5/16-18	10-24	3/8"

*Converts 5/16-18 Thread to 10-24 Thread*

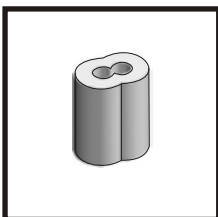

### Wire Crimp Sleeve for 3/64" Wire

STOCK#  
HD-OS062

*Binds 2 pieces of 3/64" wire together using crimping plier*



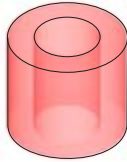

## Plastic Tubing

STOCK#	ID SIZE	OD SIZE	TUBE LENGTH
HD-PTLP1	1/2"	5/8"	1/4"
HD-PT250	5/16"	7/16"	1/4"
HD-PT375	5/16"	7/16"	3/8"
HD-PT500	5/16"	7/16"	1/2"

Used to isolate glass panels from metal studs in Standoff Cap applications.

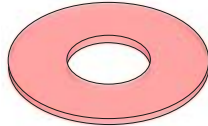

## Neoprene Washers

STOCK#	ID SIZE	OD SIZE	FOR BARREL
HD-NW563	5/16"	9/16"	5/8"
HD-NW750	5/16"	3/4"	7/8"
HD-NW875	5/16"	7/8"	1"
HD-NW1.125	5/16"	1-1/8"	1-1/4"
HD-NW1.375	5/16"	1-3/8"	1-1/2"

Used to isolate glass panels from metal barrels and caps in Standoff applications

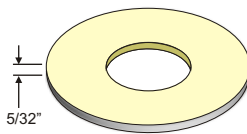

## Nylon Washers

STOCK#	ID SIZE	OD SIZE
HD-NW1	5/16"	1/2"
HD-NW2	5/16"	3/4"

Used as a spacer and to lessen friction where two metal pieces meet and rub.

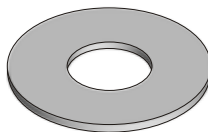

## Metal Washers

STOCK#	ID SIZE	OD SIZE
HD-MW1	3/16"	7/16"
HD-MW3	5/16"	3/4"
HD-MW4	5/16"	1-1/4"

Used as a spacer or to allow a screw to be used in an oversized hole.



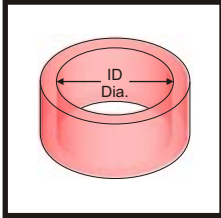

### Gripper Sleeve Tool

STOCK#	ID SIZE
HD-GPS1	3/8"
HD-GPS2	5/8"
HD-GPS3	7/8"
HD-GPS4	1"
HD-GPS5	1-1/4"

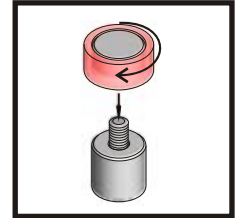

*Gripper Sleeve Tools are used to protect Standoff Caps and Barrels while securely tightening*

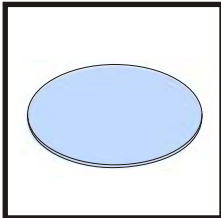

### Neoprene Wrench

STOCK#	DIAM. SIZE
HD-NW	3"



*The Neoprene Wrench is used to tighten the Standoff Low Profile Caps.*



### Allen Drivers

STOCK#	SIZE
HD-AW1	1/16"
HD-AW2	3/32"
HD-AW4	5/32"
HD-AW5	ALL



### Thread Locker (Loctite)

STOCK#	STRENGTH	SIZE
HD-TL1	MEDIUM	10ml
HD-TL3	HIGH	10ml









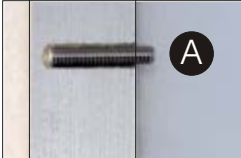

*Used to lock hardware in place. Medium strength is removable. High strength is permanent.*

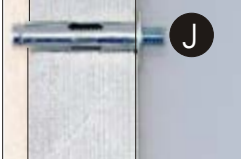

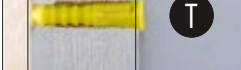

# Installation Techniques

## CONCRETE - BRICK - STONE - STUCCO

ANCHOR	PROCEDURE	APPLICATION
	<b>THREADED STUD</b> EPOXIED INTO DRILLED HOLE CONCRETE - BRICK - STONE	
	<b>CONCRETE SLEEVE ANCHOR</b> WEDGED INTO DRILLED HOLE CONCRETE - BRICK - STONE	
	<b>CONCRETE EXPANSION NUT</b> WEDGED INTO DRILLED HOLE CONCRETE - BRICK - STONE	
	<b>PLASTIC WALL ANCHOR (FOR #8 SCREW)</b> INSERTED INTO DRILLED HOLE CONCRETE - BRICK - STONE - STUCCO	

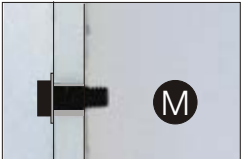
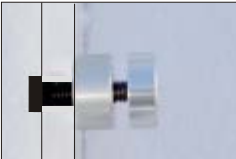
## METAL - PLASTIC - COMPOSITE MATERIAL

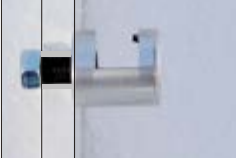
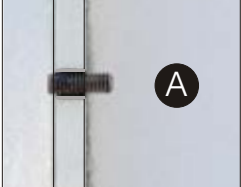
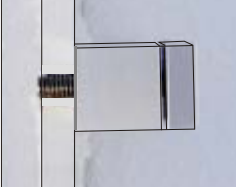
ANCHOR	PROCEDURE	APPLICATION
	<b>LOW HEAD OR MACHINE SCREW</b> INSERTED INTO DRILLED HOLE <i>You must have access to the back side</i> METAL - PLASTIC - COMPOSITE MATERIAL	
	<b>LOW HEAD SCREW</b> INSERTED THROUGH COMPONENT INTO DRILLED HOLE AND NUT <i>You must have access to the back side</i> METAL - PLASTIC - COMPOSITE MATERIAL	
	<b>THREADED STUD</b> 5/16" - 18 HOLE IS TAPPED DIRECTLY INTO THE PANEL METAL - PLASTIC - COMPOSITE MATERIAL	



# Anchor Installation Techniques

## DRYWALL - PANELLING

### ANCHOR

### PROCEDURE

### APPLICATION

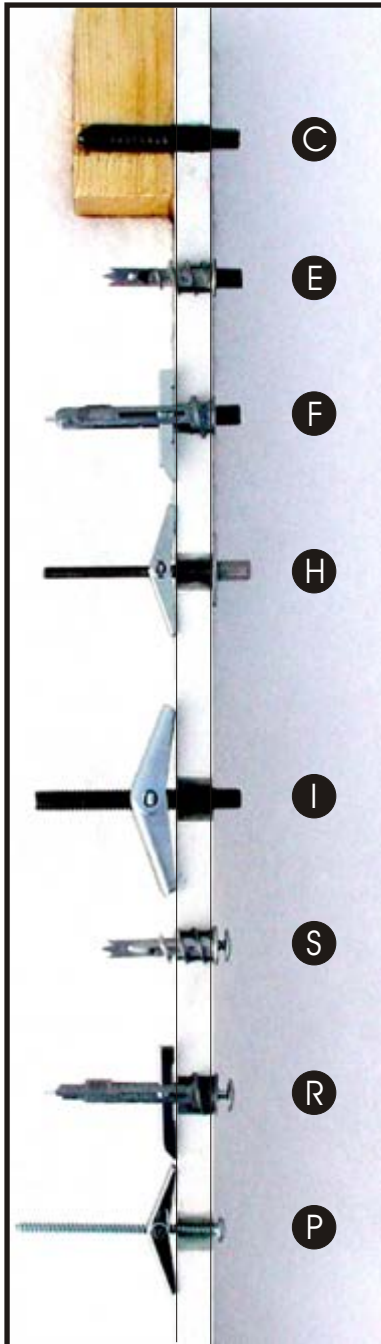

**WOOD MOUNT HANGER SCREWS**  
USED WHERE THERE IS WOOD BACKING  
USE DOUBLE NUT TECHNIQUE TO DRIVE

**WALL BOARD STUD ASSEMBLY**  
COMBINATION SCREW WITH E-Z ANCHOR  
5/32" HEX HEAD DRIVER REQUIRED TO DRIVE

**SELF DRILLING TOGGLE ANCHOR**  
COMBINATION SCREW WITH E-Z TOGGLE  
5/32" HEX HEAD DRIVER REQUIRED TO DRIVE

**10-24 TOGGLE BOLT ANCHOR**  
ASSEMBLY INCLUDES 10-24 TOGGLE WING  
10-24 TO 5/16-18 THREADED INSERT  
WASHER AND 10-24 X 3" STUD  
USED WITH 1" AND LARGER DIAMETER BARRELS

**5/16-18 TOGGLE BOLT ANCHOR**  
ASSEMBLY INCLUDES 5/16-18 TOGGLE WING  
AND 5/16-18 X 3" STUD  
USED WITH 1-1/4" AND LARGER DIAMETER BARRELS

**1-1/4" WAFERHEAD SCREW INTO  
SELF DRILLING WALLBOARD ANCHOR**  
USED TO MOUNT EDGE, SHELF & MATERIAL GRIPPERS

**2" LONG MACHINE SCREW INTO  
SELF DRILLING TOGGLE ATTACHMENT**  
USED TO MOUNT EDGE, SHELF & MATERIAL GRIPPERS

**10-24 X 3" PAN HEAD SCREW INTO  
SMALL TOGGLE ATTACHMENT**  
USED TO MOUNT EDGE, SHELF & MATERIAL GRIPPERS

